



**ST. CLAIR CATHOLIC
DISTRICT SCHOOL BOARD**

Lighting the Way ~ Rejoicing in Our Journey

**REQUEST FOR TENDER
FOR
TENDER #: 653-CP1901
New North Chatham Catholic Elementary School**

ADDENDUM #5 - CLARIFICATION

ISSUED: June 5, 2018.

DUE DATE: June 7, 2018 at 2:00:00p.m., Local Time

Mailing Address:
Mr. Tony Prizio
Purchasing Department
St. Clair Catholic District School Board
420 Creek Street
Wallaceburg, ON
N8A 4C4

This addendum forms part of the contract documents and modifies the original specifications and drawings as follows. Acknowledge receipt of this addendum in the space provided on the Form of Tender.

ARCHITECTURAL SPECIFICATIONS

1. Millwork Details
 1. ADD Millwork Detail as shown on Drawing ASK-016, attached.
 2. ADD Millwork Detail as shown on Drawing ASK-017, attached.
 3. ADD Millwork Detail as shown on Drawing ASK-018, attached.

ARCHITECTURAL DRAWINGS

2. Drawing A8.05 Interior Elevations
 1. **ON 110 - KINDERGARTEN – EAST ELEVATION (MIRRORED), 112 & 114 – KINDERGARTEN – EAST ELEVATION, 116 – KINDERGARTEN – NORTH ELEVATION (MIRRORED), 118 – KINDERGARTEN – NORTH ELEVATION: REVISE DETAIL TAG FROM “1/MW28” TO “1/ASK-016”. REFER TO ATTACHED DRAWING.**
3. Drawing A8.06 Interior Elevations
 1. **ON TYPICAL GROUND FLOOR CLASSROOM – COORDINATE WITH PLANS, CLASSROOM 128 / 132, CLASSROOM 126 / 130 / 134 (MIRRORED) – WINDOW WALL: REVISE DETAIL TAG “1/MW28” TO “1/ASK-016”. REFER TO ATTACHED DRAWING.**
4. Drawing A8.08 Interior Elevations
 1. **ON TYPICAL SECOND FLOOR CLASSROOM – COORDINATE WITH PLANS, CLASSROOM 210 / 214 / 218 / 224 / 236 / 240 / 246, CLASSROOM 212 / 220 / 222 / 234 / 238 / 242 (MIRRORED) – WINDOW WALL: REVISE DETAIL TAG “1/MW28.1” TO “1/ASK-017”. REFER TO ATTACHED DRAWING.**
5. Drawing A8.09 Interior Elevations
 1. **ON 208 – CLASSROOM - EAST ELEVATION: REVISE DETAIL TAG “1/MW28.1” TO “1/ASK-017”. REFER TO ATTACHED DRAWING.**
 2. **ON 246 – CLASSROOM – SOUTH ELEVATION: REVISE DETAIL TAG “1/MW27.1” TO “1/ASK-018”. REFER TO ATTACHED DRAWING.**

THIS CONCLUDES ADDENDUM #5.
+ Drawings ASK-016 to ASK-018 inclusive.

WALL CONSTRUCTION VARIES,
REFER TO FLOOR PLANS

PLASTIC LAMINATE TOP ON 19mm
PW3

13mm x 38mm CONTINUOUS SW1 c/w
10mm RADIUS EDGE

19mm PPW BACK AND SHELF

19mm PPW GABLES

19mm PPW BACK AND BOTTOM

REFER TO ROOM FINISH
SCHEDULE FOR BASE

T.O. FIN. FLOOR

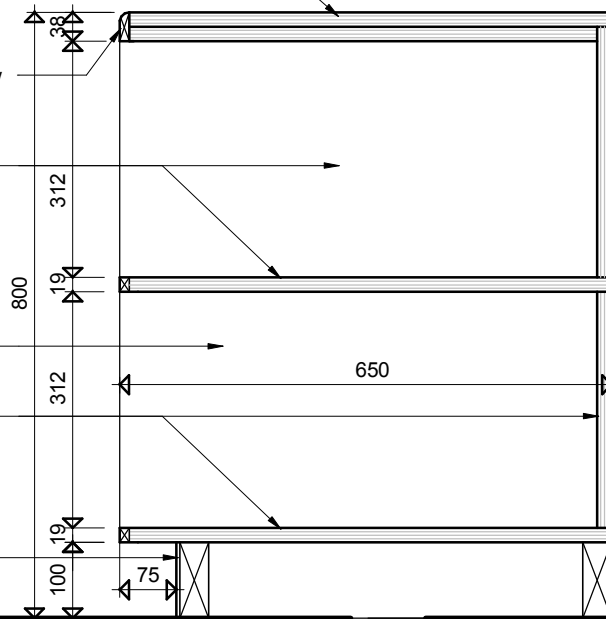

North Chatham Catholic Elementary School

801 McNaughton Avenue West, Chatham Ontario St. Clair Catholic District School Board

Project No.:

886

OPEN SHELF - 650mm @ GROUND FLOOR

Plot Date:

2018-06-05

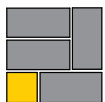

CORNERSTONE
ARCHITECTURE **E**

110-700 Richmond St. London ON Canada N6A 5C7
P 519 432 6644 F 519 432 6737

cornerstonearchitecture.ca

© 2018 Cornerstone Architecture Incorporated. All Rights Reserved.

ASK-016

WALL CONSTRUCTION VARIES,
REFER TO FLOOR PLANS

PLASTIC LAMINATE TOP ON 19mm
PW3

13mm x 38mm CONTINUOUS SW1 c/w
10mm RADIUS EDGE

19mm PPW BACK AND SHELF

19mm PPW GABLES

19mm PPW BACK AND BOTTOM

REFER TO ROOM FINISH
SCHEDULE FOR BASE

T.O. FIN. FLOOR

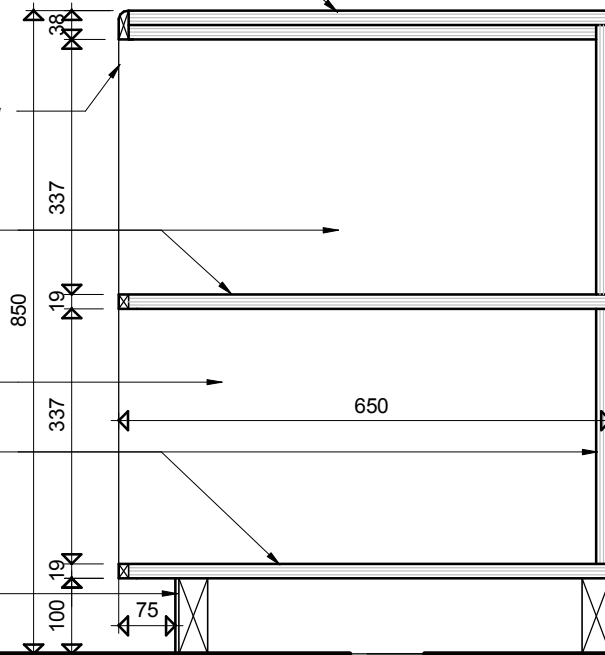

North Chatham Catholic Elementary School

801 McNaughton Avenue West, Chatham Ontario St. Clair Catholic District School Board

Project No.:

886

OPEN SHELF - 650mm @ SECOND FLOOR

Plot Date:

2018-06-05

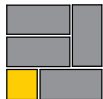

CORNERSTONE
ARCHITECTURE **E**

110-700 Richmond St. London ON Canada N6A 5C7
P 519 432 6644 F 519 432 6737

cornerstonearchitecture.ca

© 2018 Cornerstone Architecture Incorporated. All Rights Reserved.

ASK-017

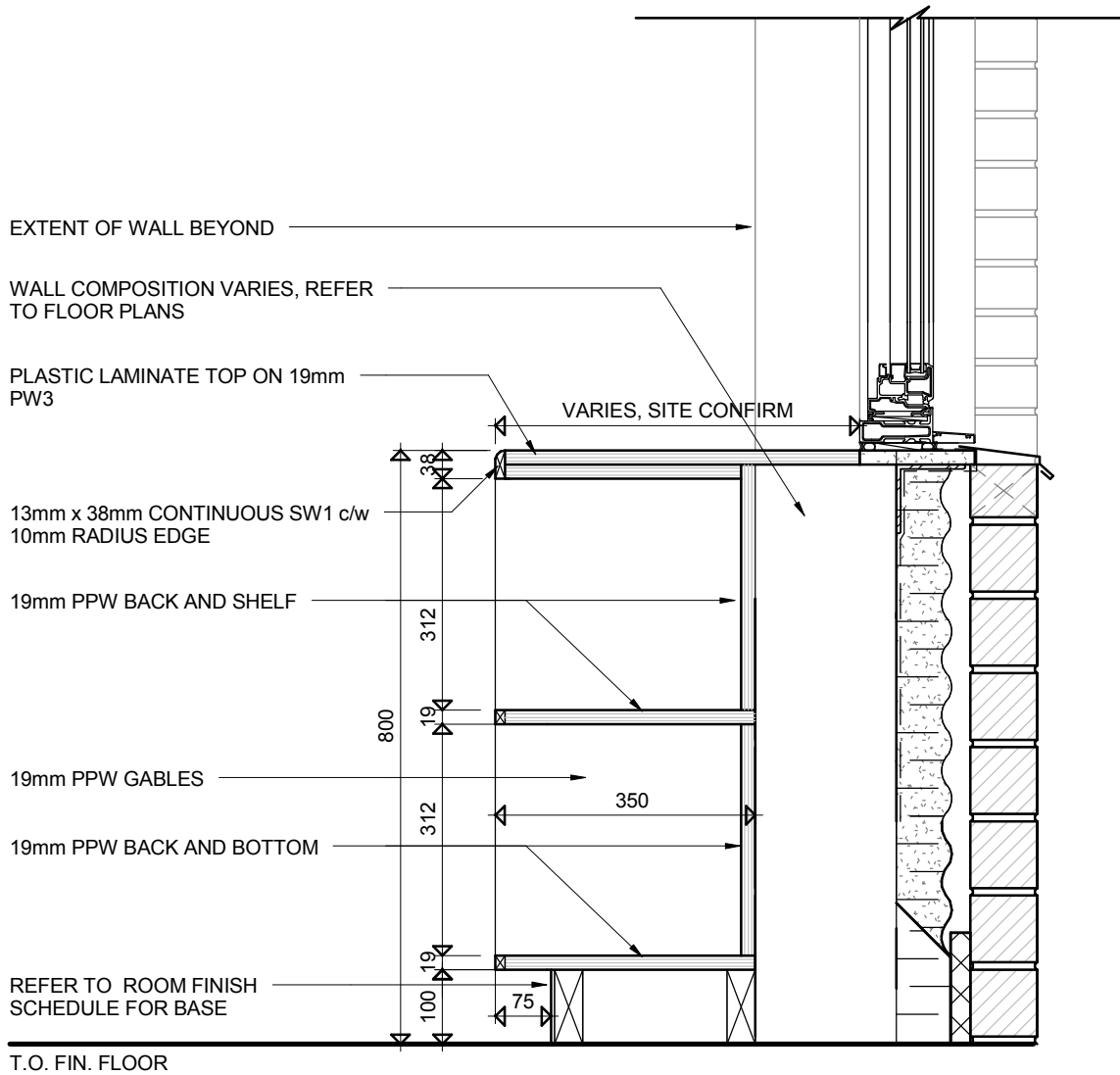

North Chatham Catholic Elementary School

801 McNaughton Avenue West, Chatham Ontario St. Clair Catholic District School Board

Project No.:

886

OPEN SHLEF AT WINDOW IN CLASSROOM 246

Plot Date:

2018-06-05

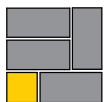

CORNERSTONE
ARCHITECTURE **E**

110-700 Richmond St. London ON Canada N6A 5C7
P 519 432 6644 F 519 432 6737

cornerstonearchitecture.ca

© 2018 Cornerstone Architecture Incorporated. All Rights Reserved.

ASK-018